

Warnings

Re-use of this single use product may create a potential risk to the user. Reprocessing, cleaning, disinfection and sterilization may compromise product characteristics which in turn create an additional risk of physical harm to or infection of the patient.

This product contains phthalates and should not be used by either children or pregnant or nursing women without consulting a physician.

Caution

Single-use only

Coloplast accepts no liability for any injury or other loss that may arise in the use of this product in a manner contrary to Coloplast's current recommendations.

Indications

Bag for collection of urine. The bag is connected to a tube.

Information

The bedside drainage bag has a 2000ml capacity with an inlet tube of 100cm. It is available with or without outlet tap.

The bedside drainage bag is designed for attachment to your daytime drainage system, (e.g. leg bag) to create a closed collection system for secure overnight drainage. The bag can also be connected directly to a urisheath or catheter.

How to use the bedside drainage bag

Connecting to a urisheath or catheter

1.



1. Attach the inlet connector of the bedside drainage bag securely to the urisheath (shown) or catheter (not shown).

Make sure that neither the urisheath, nor the catheter or bag tubing is bent or kinked so as not to obstruct the flow of urine.

Connecting to a leg bag (overnight link system)

2.

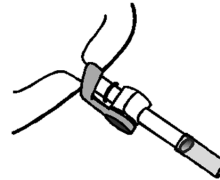

2. To set up an overnight link system, your leg bag must be fitted with a connector on the outlet tap, typically a short piece of flexible silicone tubing.

Ensure that your leg bag is pre-fitted with an outlet connector to allow for attachment of a bedside drainage bag.

Do not disconnect the leg bag from the catheter or urisheath.

3.

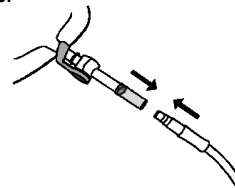

3. Connect the bedside drainage bag to the leg bag by pushing the inlet connector of the bedside drainage bag firmly into the outlet connector of the leg bag.

4. Switch the leg bag outlet tap to the open position to allow for continuous drainage.

5. Loosen the leg bag straps to provide comfort as well as reducing the likelihood of disconnection from the sheath or catheter.

6.

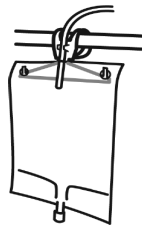

6. Use a Conveen or Simpla stand or hanger to provide security and support for the bedside drainage bag and to ensure the free flow of urine.

7. In the morning, close the leg bag outlet tap, disconnect the bedside drainage bag and re-adjust the leg bag straps around the leg.

Emptying the bag with outlet tap

To empty the bag, position the outlet tap over a toilet bowl or other suitable receptacle and open the tap.

Always remember to close the tap after emptying.

8. A.

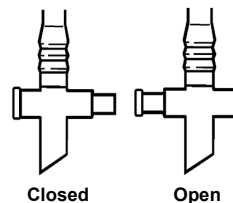

8. A. SLIDE-ACTION TAP (Conveen Basic, Simpla S3): On one end of the sliding barrel is a collar, when this end is pushed in, the tap is closed. To open, slide the tap in the opposite direction.

8. B.

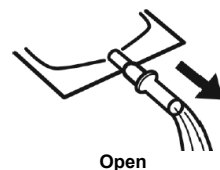

8. B. PUSH-PULL TAP (Conveen Basic): To open, pull down on the tap cylinder. To close, push the tap cylinder back to its original position closest to the bag.

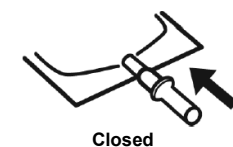

Emptying the bag without outlet tap

Position the bag over a toilet bowl or other suitable receptacle.

9. A

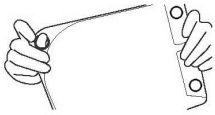

9. A To empty the bag punch out the bottom hole and the top hole opposite the tear mark.

9. B



9. B Tear along the strip at the top of the bag.

9. C

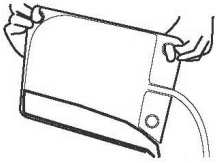

9. C Empty the bag by holding it by the hole at the bottom of the bag and the hole opposite the pouring lip.

10. Change the bag according to local guidelines and recommendations.

Symbol

WO	Work order. Production number identifying the packaging of a specific order. (LOT-number relates to production run).
 DEHP	Contains or presence of phthalate: bis (2-ethylhexyl) phthalate (DEHP)